



PEUGEOT

NOT 2757

Réf : 16 106 680 80

Réf : 16 106 262 80

# 208 - 2008

(A90 - A91)

(A94)

FR NOTICE DE POSE A USAGE PROFESSIONNEL / LES PHOTOS ET LES DESSINS NE SONT PAS CONTRACTUELS  
 GB FITTING INSTRUCTIONS FOR PROFESSIONAL FITTERS / THE PHOTOGRAPHS AND THE DRAWINGS ARE NOT CONTRACTUAL  
 ES INSTRUCCIONES DE MONTAJE PARA USO PROFESIONAL / LAS FOTOGRAFIAS Y LOS DIBUJOS NO SON CONTRACTUALES  
 P MANUAL DE MONTAGEM PARA UTILIZAÇÃO PROFISSIONAL / AS FOTOGRAFIAS E OS DESENHOS NÃO SÃO CONTRATUAIS  
 DE MONTAGEANLEITUNG FÜR PROFESSIONNELLEN EINSATZ / DIE FOTOS UND DIE ZEICHNUNGEN SIND NICHT VERTRAGLICH  
 IT ISTRUZIONI DI POSA AD USO PROFESSIONALE / LE FOTOGRAFIE ED I DISEGNI NON SONO CONTRATTUALI  
 NL MONTAGEHANDLEIDING VOOR PROFESSIONNEEL GEBRUIK / DE FOTO'S EN DE TEKENINGEN ZIJN NIET CONTRACTUEEL

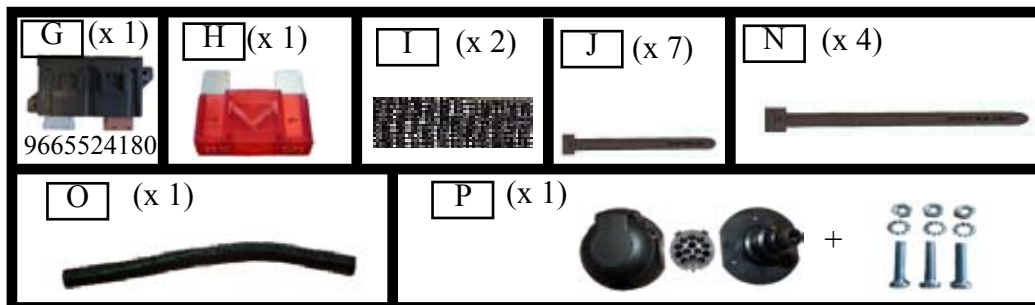
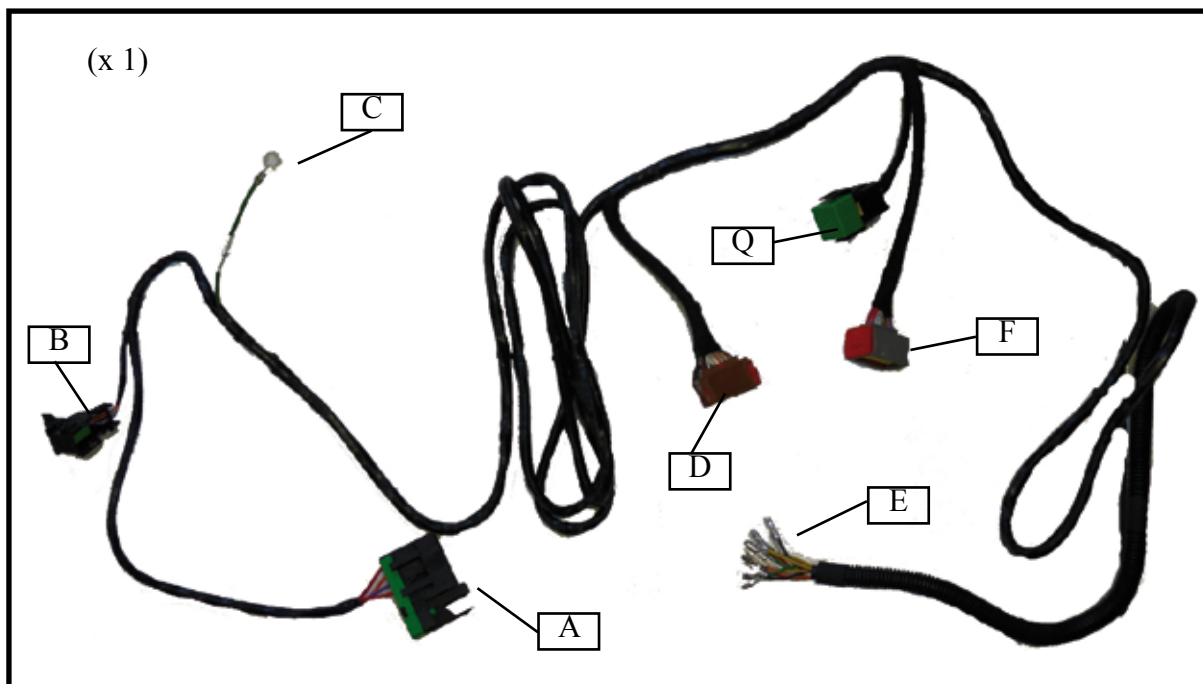

Date de création : 28/06/2017  
 Indice d'évolution : IND.B  
 Date de modification :

# 208

(A90 - A91)

+

# 2008

(A94)

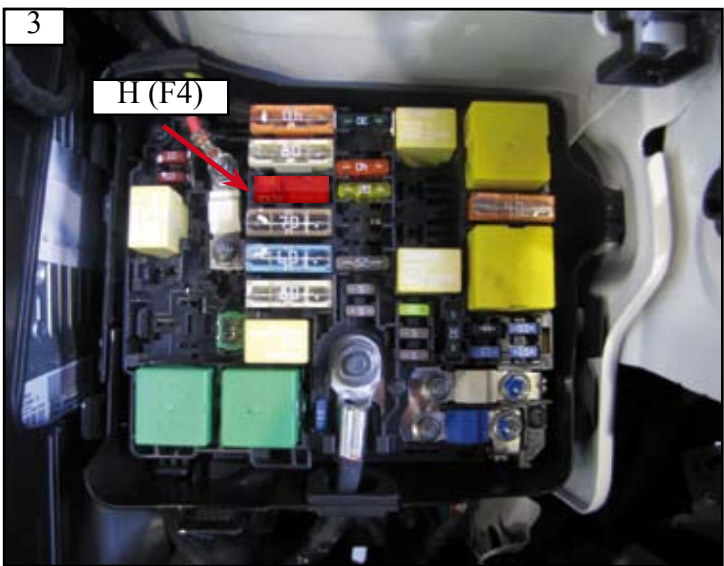
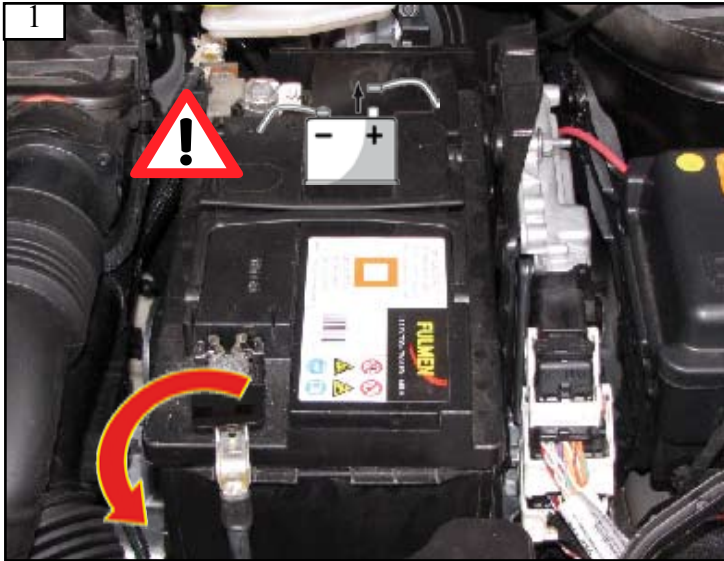

# 208

(A90 - A91)

# 2008

(A94)



# 208

(A90 - A91)

# 2008

(A94)



# 208

(A90 - A91)



# 2008

(A94)

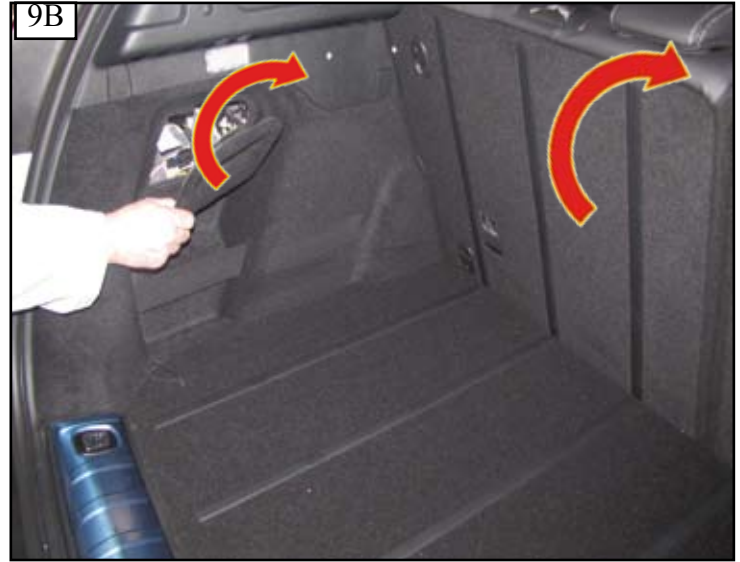

# 208

(A90 - A91)

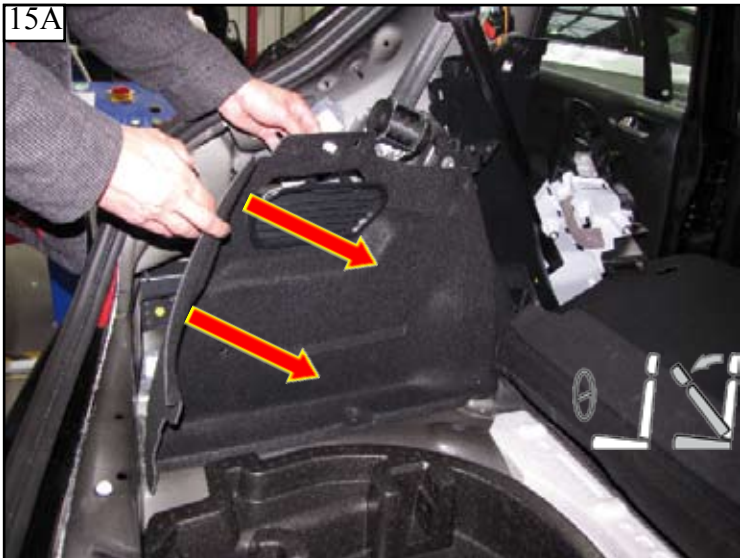

# 2008

(A94)

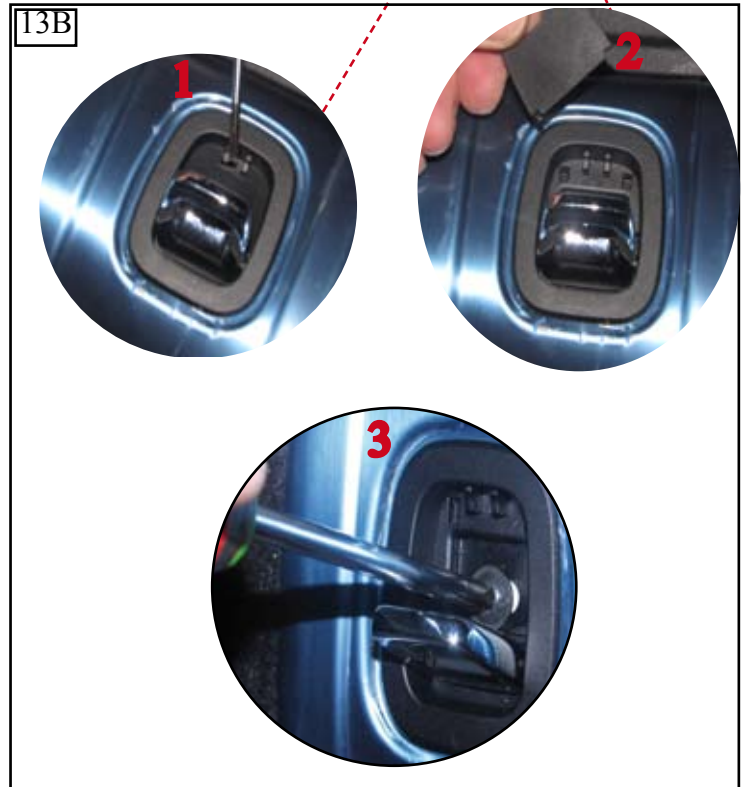
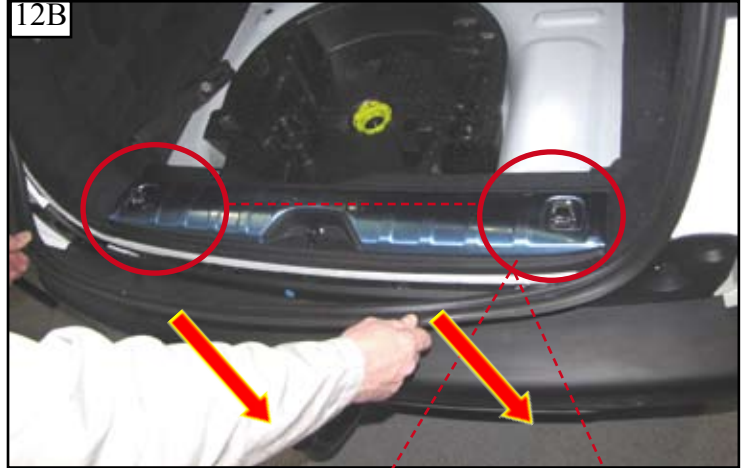

# 208

(A90 - A91)

# 2008

(A94)

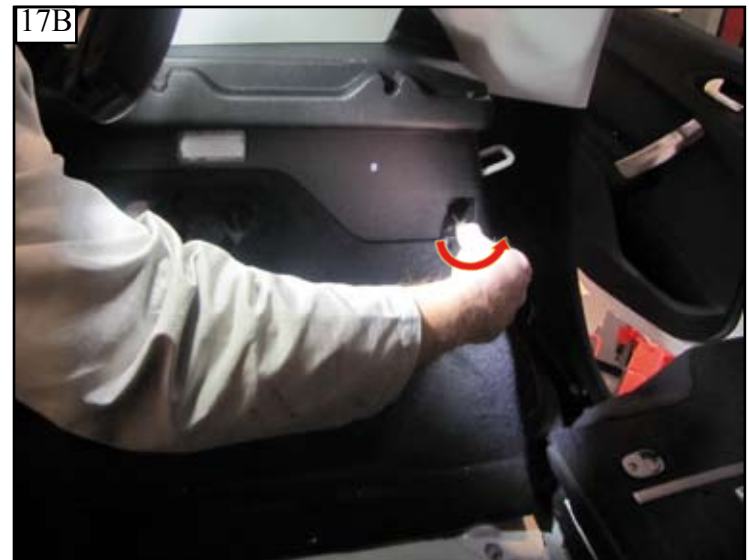

P8/21

# 208

(A90 - A91)

# 2008

(A94)



P8/21



# 208

(A90 - A91)

+

# 2008

(A94)

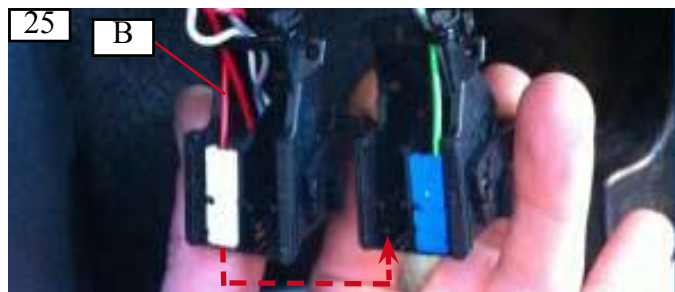
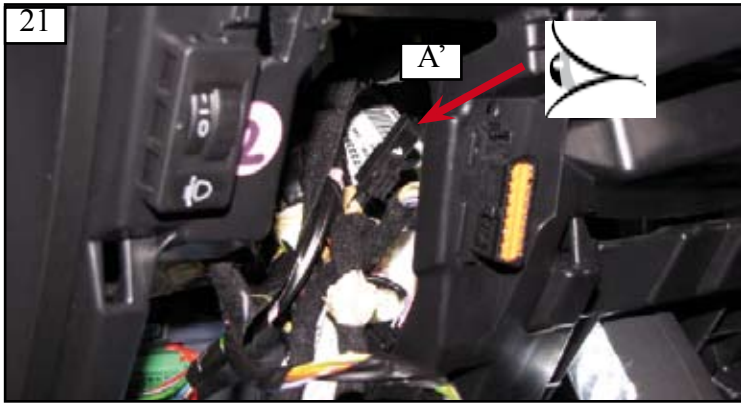

# 208

(A90 - A91)

+

# 2008

(A94)

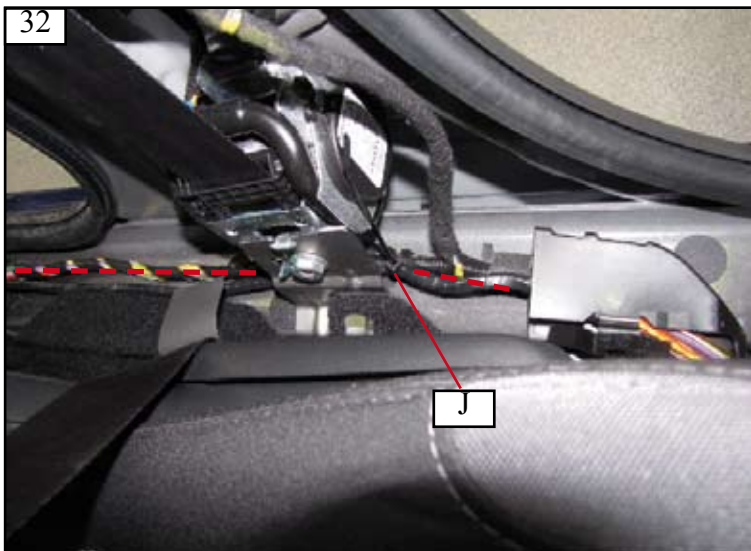
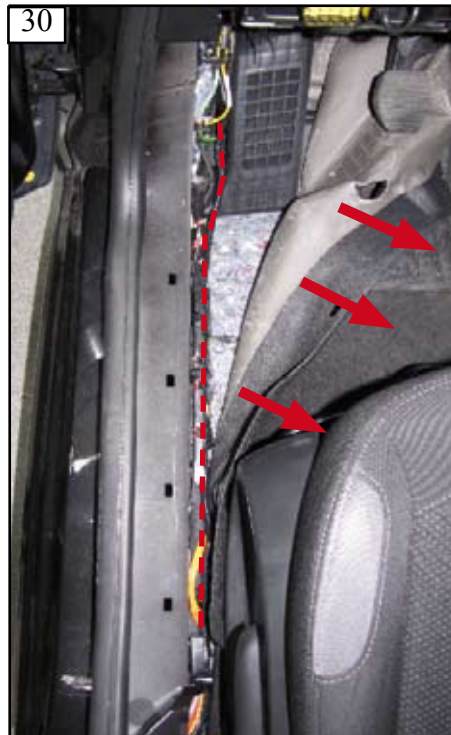
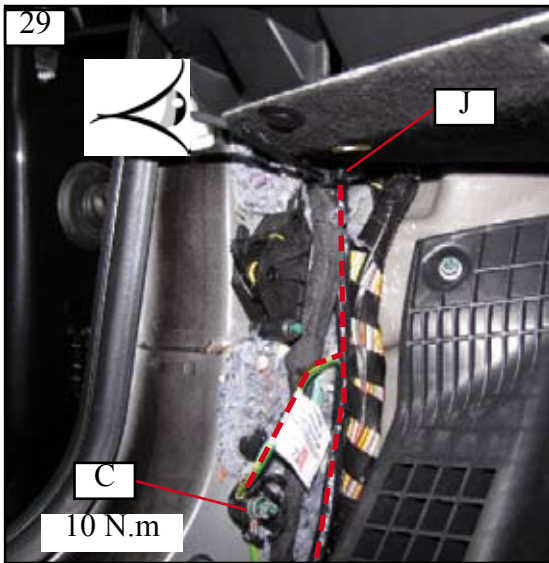
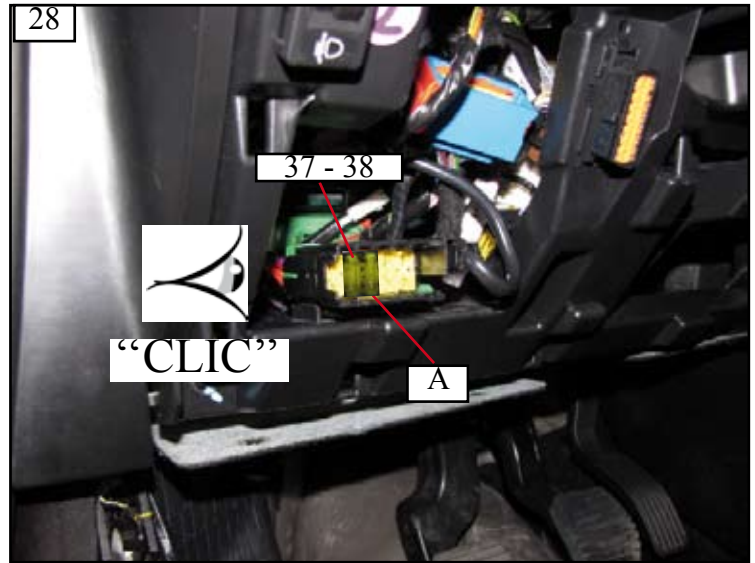
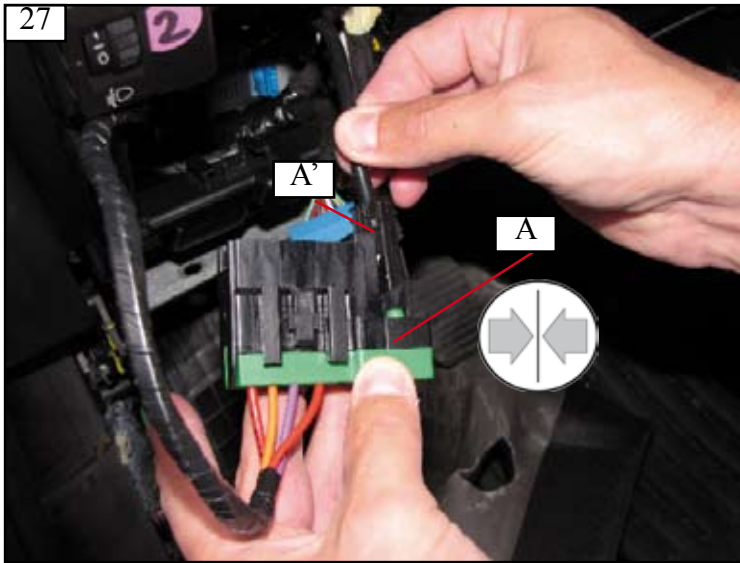

# 208

(A90 - A91)

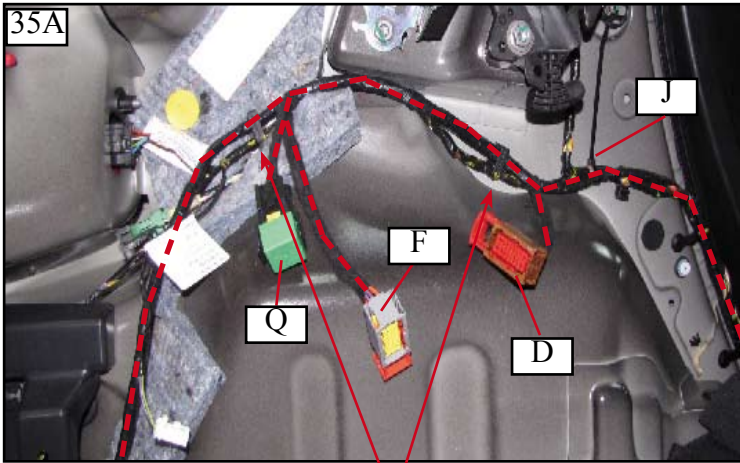
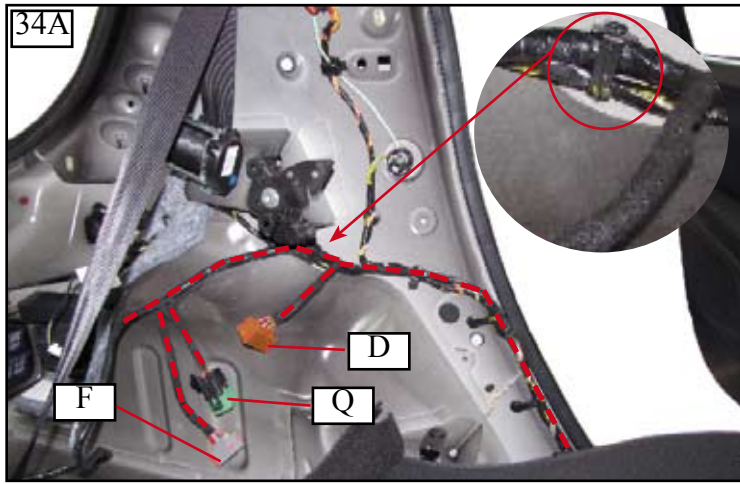

# 2008

(A94)



# 208 + 2008

(A90 - A91) (A94)

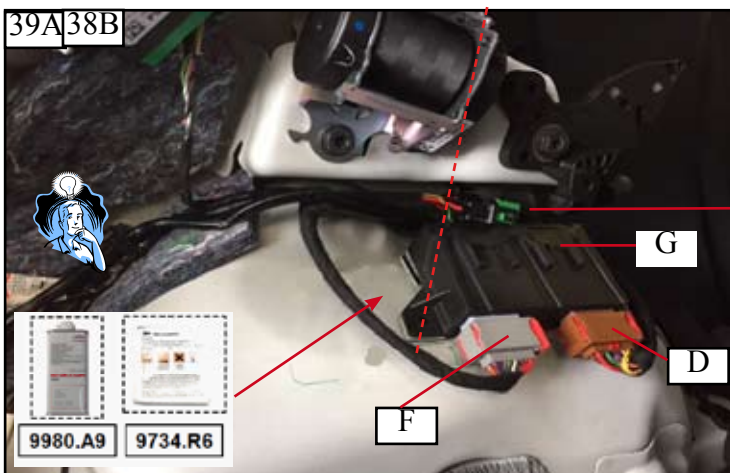
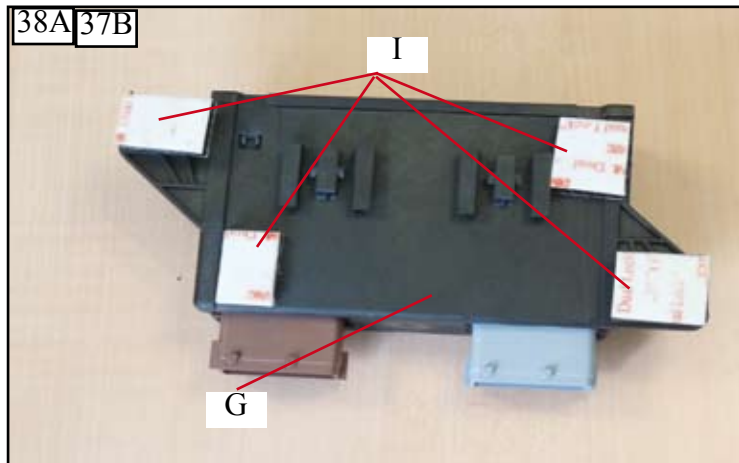
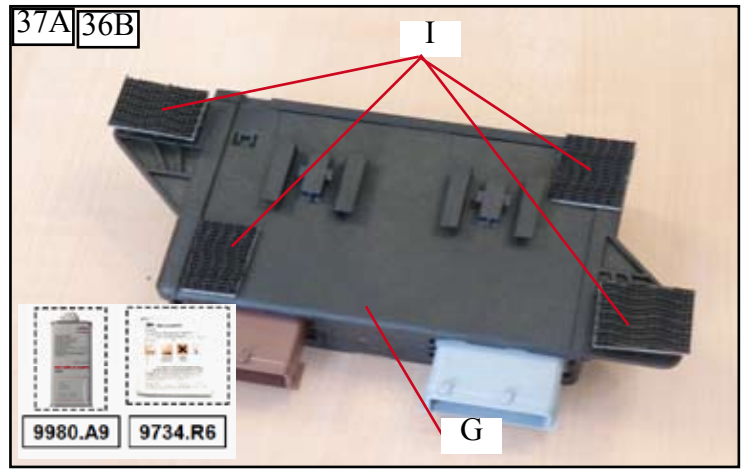
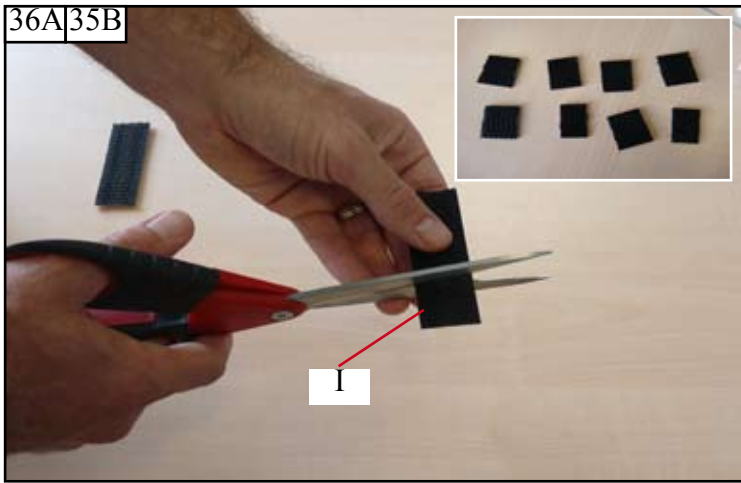

# 208

(A90 - A91)

# 2008

(A94)

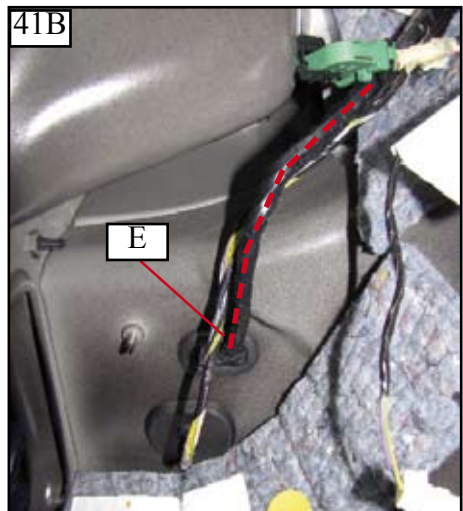

# 208

(A90 - A91)

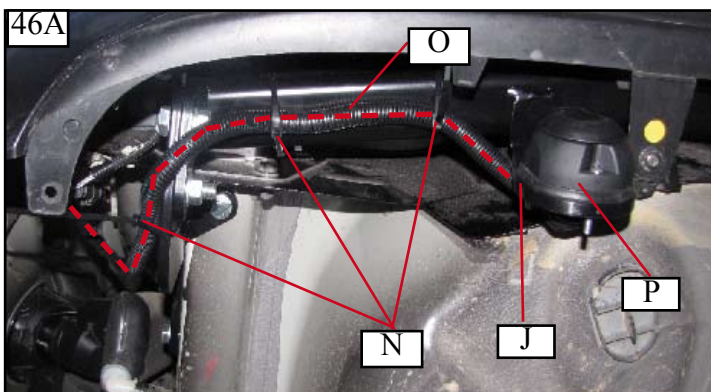
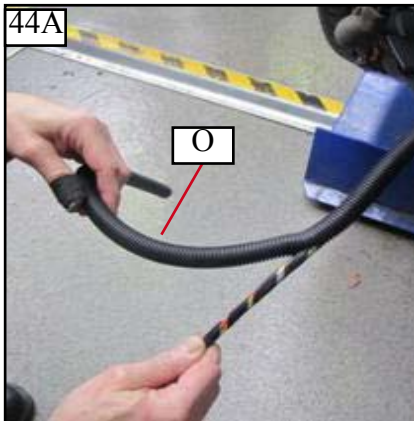
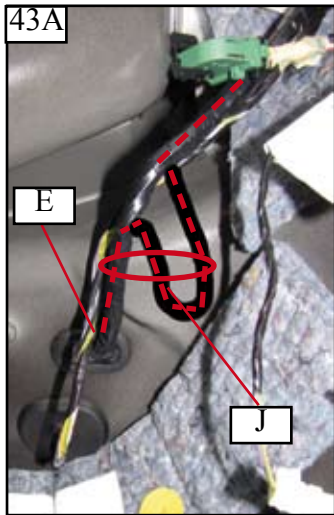

# 2008

(A94)

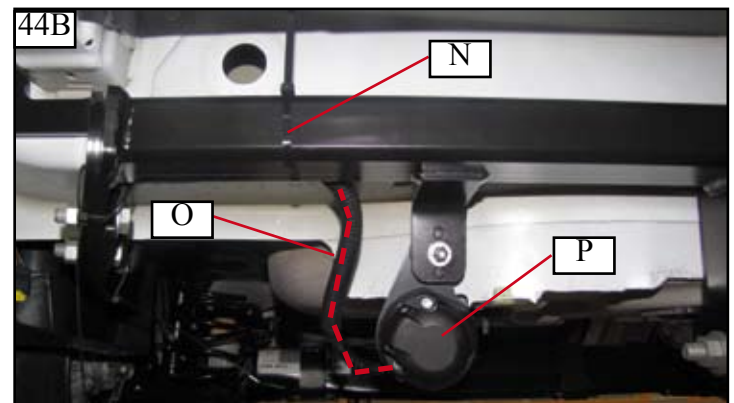
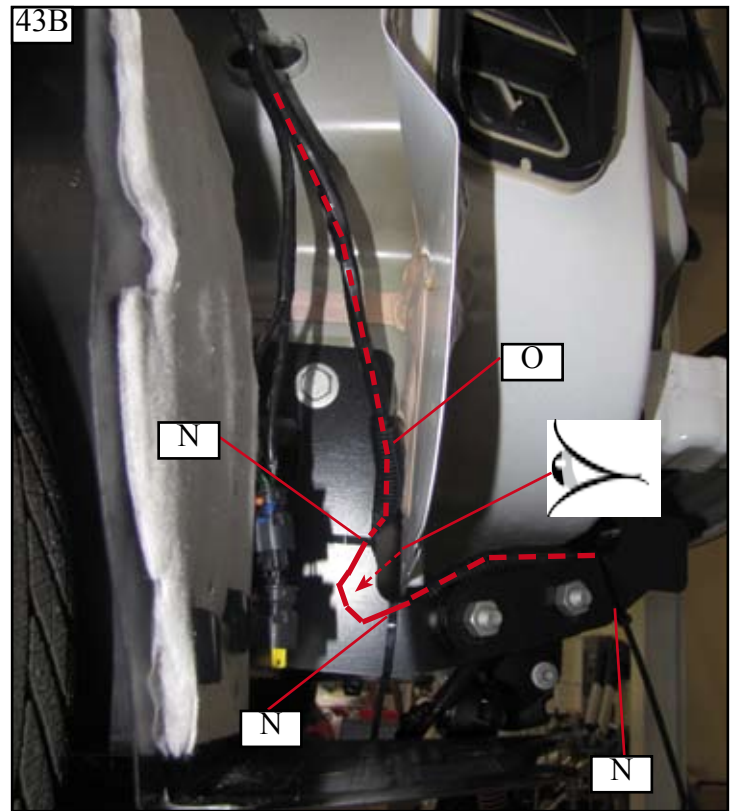
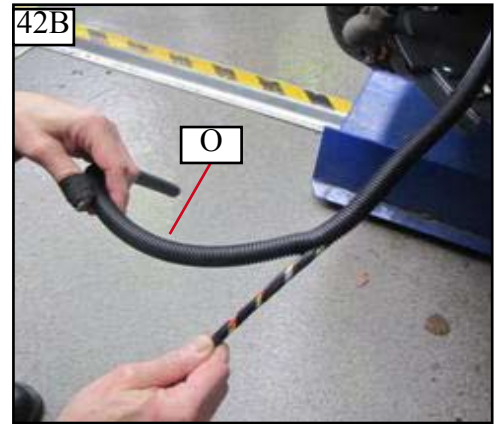

# 208

(A90 - A91)

+

# 2008

(A94)

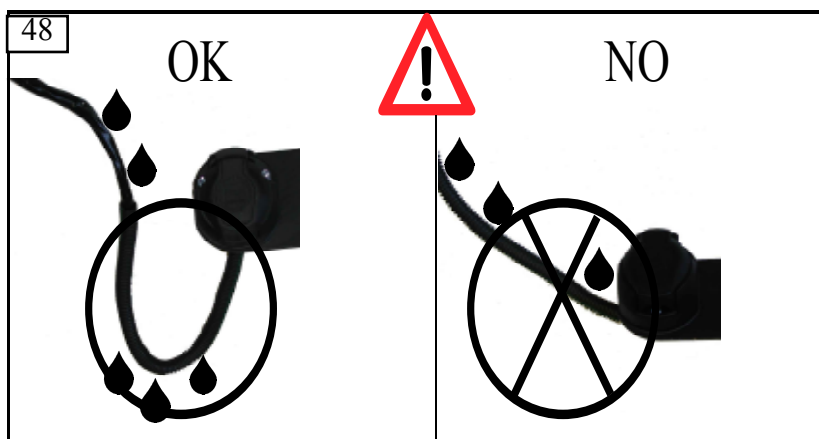

## DIAG BOX

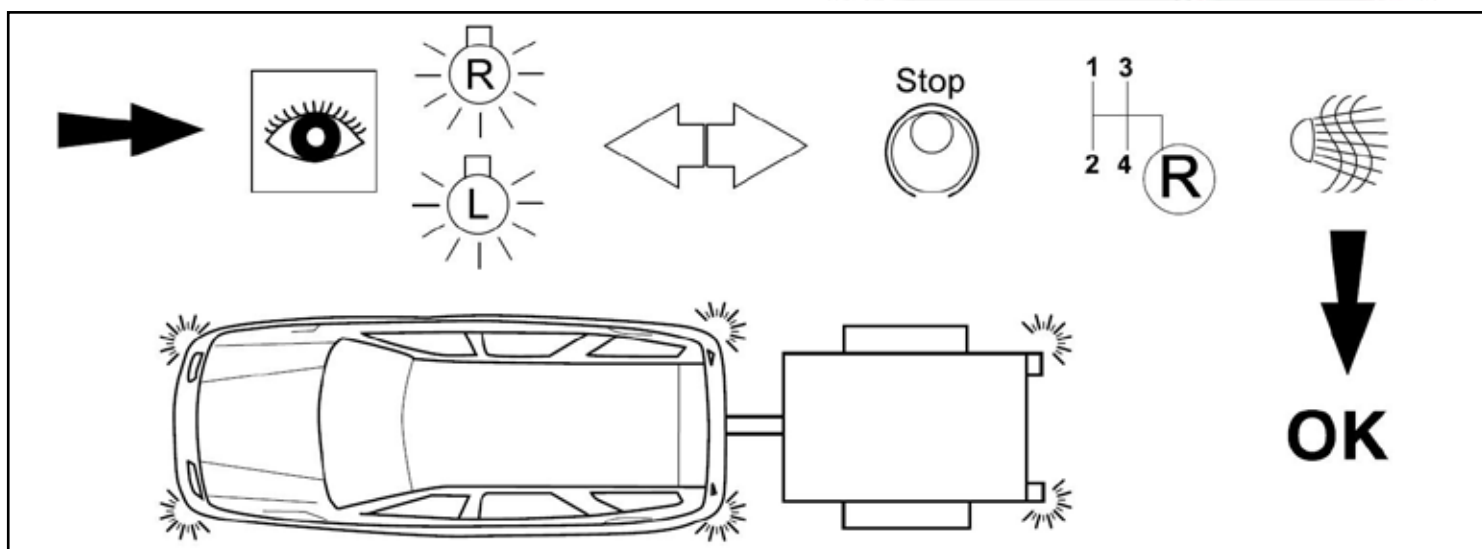

FR : Après le test de fonctionnement, remonter les pièces dans le sens inverse du démontage

GB : After the run test, reassemble in reverse order

ES : Después de la ejecución de la prueba, volver a montar en el orden inverso









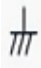

P : Após o ensaio, remontar na ordem inversa

DE : Nach dem Testlauf in umgekehrter Reihenfolge wieder zusammenbauen

IT : Dopo la prova di funzionamento, rimontare in ordine inverso

NL : Na het proefdraaien, monteer in omgekeerde volgorde



-  **1 L** 28A9 : fil jaune, yellow wire, gelbes kabel, filo giallo, gele draad, fio amarelo, hilo amarillo, gul kabel
-  **2/54g** 20A0 : fil orange, orange wire, oranges kabel, filo arancio, oranje draad, fio laranja, hilo naranja, orange kabel
-  **3/31** MC88D : fil vert/jaune 2.5<sup>2</sup>, 2.5<sup>2</sup> green/yellow wire, grün/gelbes kabel 2.5<sup>2</sup>, filo verde/giallo 2.5<sup>2</sup>, groen/gele 2.5<sup>2</sup> draad, fio verde/amarelo 2.5<sup>2</sup>, hilo verde/amarillo 2.5<sup>2</sup>, gul/gron kabel 2.5<sup>2</sup>
-  **4/R** 29A0 : fil vert, green wire, grünes kabel, filo verde, groene draad, fio verde, hilo verde, gron kabel
-  **5/58R** 26A4 : fil beige, beige wire, beiges kabel, filo beige, beige draad, fio bege, hilo beige, beige kabel
-  **6/54** 21B1 : fil violet, violet wire, violettes kabel, filo violeta, violet kleurige, fio violeta, hilo violeta, violett kabel
-  **7/58L** 26A3 : fil noir, black wire, qchwarzes kabel, filo nero, zwarte draad, fio negro, hilo negro, svart kabel
-  **8** 22A3 : fil blanc, white wire, weiss kabel, filo bianco, wit draad, fio branco, hilo blanco, vit kabel
- +** **9** 8834A : fil rouge 2.5<sup>2</sup>, 2.5<sup>2</sup> red wire, rotes kabel 2.5<sup>2</sup>, filo rosso 2.5<sup>2</sup>, rode 2.5<sup>2</sup> draad, fio vermelho 2.5<sup>2</sup>, hilo rojo 2.5<sup>2</sup>, röd kabel 2.5<sup>2</sup>
-  **13** MC88B : fil vert/jaune 2.5<sup>2</sup>, 2.5<sup>2</sup> green/yellow wire, grün/gelbes kabel 2.5<sup>2</sup>, filo verde/giallo 2.5<sup>2</sup>, groen/gele 2.5<sup>2</sup> draad, fio verde/amarelo 2.5<sup>2</sup>, hilo verde/amarillo 2.5<sup>2</sup>, gul/gron kabel 2.5<sup>2</sup>
-  **+** **10** 8830 : fil marron, brown wire, braun kabel, filo marrone, bruin draad, fio castanho, hilo marròn, grun kabel
-  **11** MC88C : fil vert/jaune 2.5<sup>2</sup>, 2.5<sup>2</sup> green/yellow wire, grün/gelbes kabel 2.5<sup>2</sup>, filo verde/giallo 2.5<sup>2</sup>, groen/gele 2.5<sup>2</sup> draad, fio verde/amarelo 2.5<sup>2</sup>, hilo verde/amarillo 2.5<sup>2</sup>, gul/gron kabel 2.5<sup>2</sup>

BR03 → 10

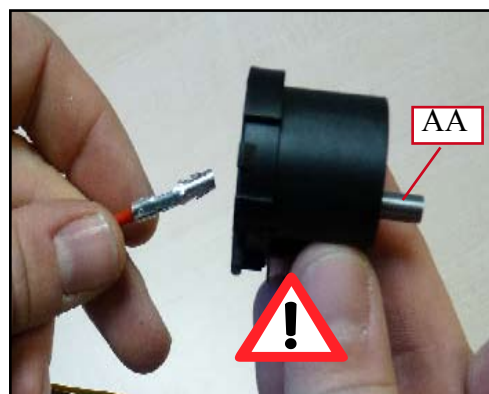
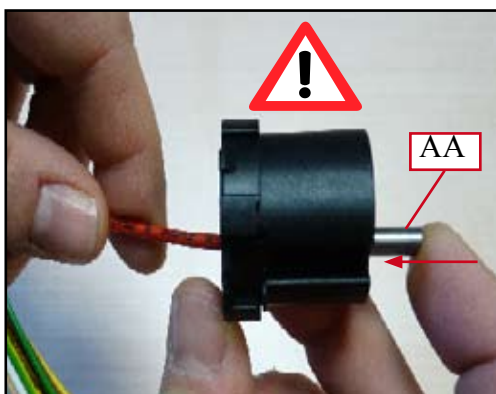





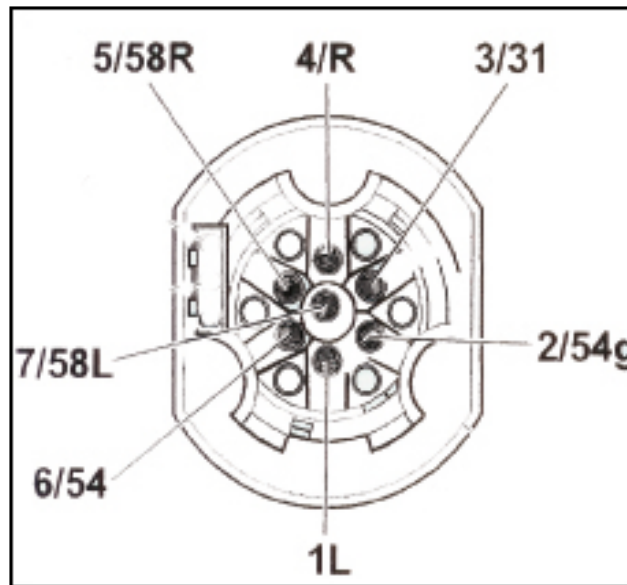

BR03 → 9



*Réf : 16 106 680 80*



-  **1 L** 28A9 : fil jaune, yellow wire, gelbes kabel, filo giallo, gele draad, fio amarelo, hilo amarillo, gul kabel
-  **2/54g** 20A0 : fil orange, orange wire, oranges kabel, filo arancio, oranje draad, fio laranja, hilo naranja, orange kabel
-  **3/31** MC88D : fil vert/jaune 2.5<sup>2</sup>, 2.5<sup>2</sup> green/yellow wire, grün/gelbes kabel 2.5<sup>2</sup>, filo verde/giallo 2.5<sup>2</sup>, groen/gele 2.5<sup>2</sup> draad, fio verde/amarelo 2.5<sup>2</sup>, hilo verde/amarillo 2.5<sup>2</sup>, gul/gron kabel 2.5<sup>2</sup>
-  **4/R** 29A0 : fil vert, green wire, grünes kabel, filo verde, groene draad, fio verde, hilo verde, gron kabel
-  **5/58R** 26A4 : fil beige, beige wire, beiges kabel, filo beige, beige draad, fio bege, hilo beige, beige kabel
-  **6/54** 21B1 : fil violet, violet wire, violettes kabel, filo vioda, violet kleurige, fio violeta, hilo violeta, violett kabel
-  **7/58L** 26A3 : fil noir, black wire, qchwarzes kabel, filo nero, zwarte draad, fio negro, hilo negro, svart kabel